

Snap Suction Hook series

Installation instructions

Suction hooks are commonly used, in modern times, to hang decorative or practical items from glass and other hard, smooth surfaces.

Other uses include securing bathroom accessories and kitchen utensils.

However there are a few things you can do to help the cup adhere better and longer to almost any hard surface.

- 1 Check the vacuum suction discs and the surface it is to be attached to.
- 2 Clean the surface thoroughly.
- 3 Press the rubber discs firmly to the surface. The tilting vacuum levers must be loose at this point and the whole of each rubber disc must lie on the surface.
if the hook comes with a safety catch, leave the catch ring lying flat on the surface.
- 4 Ensure that the rubber discs are completely on the tile area or other surfaces so that the discs do not cover any grouting lines or other joints. The discs should be positioned at least 1/2" away from all joints.
- 5 Press down the tilting lever. The resistance of the negative pressure generated must be clearly felt. The greater the resistance felt on the vacuum lever, the better the suction power of the snap hook. Buckle up the safety catch.
- 6 If the adhesion seems insufficient, release the hook and reattach again. If the required suction power has not been achieved, the hook should not be used. Give it a gentle tug to make sure it is holding tightly.

Suction cup cannot not be attached to rough or bumpy surfaces like brick and concrete wall, etc. It's difficult to stick to surfaces with pores such as wood surfaces with no coating, or wallpaper, etc.



Clean the surface thoroughly.

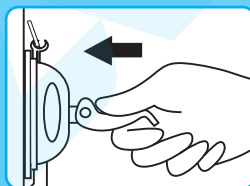

Press firmly to the surface.

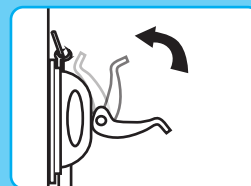

Press down the lever.

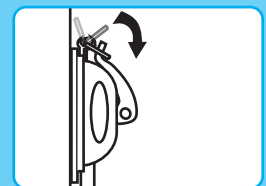

Buckle up the safety catch.

IMPORTANT:

To ensure maximum suction for a secure lasting effect, regularly remove suction product approx 2-3 months. Clean and thoroughly dry suction cup and wall surface.

NB: Porcelain/textured tiles are porous and cannot maintain suction.



CAUTION

Suction Products rely on a well prepared clean, dry surface.

Not recommended for porous surfaces e.g. porcelain, marble tiles, textured or treated tiles.

DO NOT use Suction products to hang glass frames, mirrors or fragile items.

DO NOT use Suction products above beds or positions where failure could cause injury.

Hanlix accepts no responsibility for any loss or damage by any person as a result of the use or misuse of these goods.

In case of any defect in the goods, Hanlix liability shall be limited solely to replacement of the defective goods.